

**ALBATROSS[®] USA
INC**



**OPERATING INSTRUCTION
MANUAL**

“HYDROSOLV Jr.”

SERIAL N° _____

To obtain the maximum benefit from the unique design of the "COLD SPOTTING TABLE" it is essential to adhere to the following instructions:

1. INSTALLATION

- 1.1 The spotting board model HYDROSOLV Jr. needs to be placed on a table/support which be leveled and strong enough, with a standard height to grant a correct position for the operator.
- 1.2
 - a) Remove packing.
 - b) Place the gun support into its seating (Tab.2 Pos.23), unpack the spotting guns (Tab.2 Pos.25) and the drying gun (Tab.2 Pos.26). Attach the rilsan 6x8 tubes (Tab.2 Pos.21) to their connections placed on the air filter (Tab.2 Pos.3), attach the 4X6 rilsan tubes (Tab.2 Pos.22) to their connections placed under the liquids containers (Tab.2 Pos.4). Hang the drying gun by the nozzle (Tab.9 Pos.11) from the hook (Tab.2 Pos.30).
DO NOT BEND FLEXIBLE TUBES AT SHARP RIGHT ANGLES AS DAMAGE MAY OCCUR (Tab.2 Pos.21/22/29).
 - c) Remove all available accessories from packing (ex.: active carbon filter (Tab.3 Pos.25); steam attachment (Tab.3 Pos.1), etc.
 - d) Fill the liquids containers (Tab.2 Pos.4) - don't use aggressive or dangerous liquids both user-wise or environmentally (ex.: don't use unauthorized solvents, acids, etc.).
- 1.3 The space around the machine should guarantee an easy control of working mechanisms (ex.: cooling fans, etc.) and easy access for maintenance (ex.: suction filter cleaning and substitution, pneumatic system condensate discharge, etc.).
- 1.4 The environment must be suitably isolated from atmospheric agents (ex.: temperature not lower than +5°C or above +40°C, excessive humidity). Avoid using the machine in particularly dusty environments which could reduce the cooling of the motors.
- 1.5 The electric supply (Tab.4) must be channeled through the combination socket/plug. It is necessary to use a sectionalising and magnetothermic socket as per machine model (see serial number plate). The feeding conductor section must be equal or bigger than the power conductors section.
Before starting the machine: a) verify if the voltage is compatible with the one shown on the serial number plate.
- 1.6 The machine has to be connected to compressed air supply which must give a delivery of at least 150 l/min and minimum pressure of 8 bar and maximum 12 bar.

2. MACHINE CHARACTERISTICS

- 2.1 The machine model HYDROSOLV Jr. has an enamelled chassis (Tab.2 Pos.28) made of very strong material.

Standard equipment on machine is:

- a) Two one-way spotting guns, the spray adjustable through the trigger (Tab.2 Pos.25).
- b) One drying gun complete with stainless steel nozzle, air flow adjustable through the valve on the drying gun itself (Tab.2 Pos.26).
- c) A stainless steel spotting arm (Tab.2 Pos.27).
- d) The compressed air circuit is provided with a filter (Tab.2 Pos.3) to guarantee that the air to be used is dry, cool and without traces of oil.
- e) Pneumatic vacuum unit (Tab.2 Pos.5), 0,5 kw., 400 m³/h air capacity with a pressure of 45 mm H₂O.

The machine can also be equipped with:

- a) Double stainless steel spotting arm (Tab.3 Pos.16).
 - b) Steam attachment (Tab.3 Pos.1) complete with: electric two-way gun (Tab.3 Pos.7), for steam and for compressed air, (which substitutes the drying gun - Tab.2 Pos.26); stainless-steel steam separator tank (Tab.3. Pos.11); automatic condensate discharge (Tab.3 Pos.14) - *optional (on request only)*
 - c) Filter in stainless-steel (Tab.3 Pos.25) complete with: fluxa pre-filter panel (Tab.3 Pos.29); active carbon filter panel (Tab.3 Pos.30)
 - d) "COLA" soap tank (Tav.3 Pos.31) to be used for traditional prespotting, is made of: stainless steel tank, 8lt. capacity; pressure regulator (Tav.3 Pos.33); soap charge funnel complete with filter (Tav.3 Pos.36); safety valve (Tav.3 Pos.34); brush gun (Tav.3 Pos.37) to distribute the soap on the garments; maximum pressure supply 10 bar, working pressure 3-5 bar.
 - e) Stainless steel products holder (Tab.3 Pos.39)
- 2.2 The spotting board model HYDROSOLV Jr. has been studied for cold and steam spotting.
It is not recommended to use the working table as an ironing board or as a garment support during maintenance or repair service.
It is recommended never to spray out of the working area on the table itself (Tab.2 Pos.17).
- 2.3 The spotting board model HYDROSOLV Jr., with vacuum connected to appropriate piping, emits 61 dbA, which is a very low value and which corresponds to the most recent safety rules.
- 2.4 The emissions of the vacuum of the model HYDROSOLV Jr. should not be allowed into the working environment. The chemical characteristics of the emissions are directly related to the spotting product used.

3. IMPORTANT

- 3.1 The pneumatic on/off vacuum switch (Tab.2 Pos.11) consists of an electro-pneumatic system (Tab.2 Pos.14/16) which operates a magnetic contactor (Tab.2 Pos.15); the electric circuit has cut-out protection fuses (Tab.2 Pos.12), whilst the motor has thermic protection inside it (Tab.4 - "IT" type).

To start the vacuum, step on the pedal (Tab.2 Pos.16) and step on it again to stop it: *IT IS RECOMMENDED not to keep the foot over the pedal, but press it and lift foot off immediately.*

- 3.2 To obtain the maximum benefit from the unique design of the "cold spotting table" it is important to follow these points:

Before starting to work please **REMEMBER : NEVER** act directly on the stain, but operate starting from the outer extremity of the stain using the gun in a circular motion to the center of the stain itself as shown in drawing N°1.

a) The spraying gun (Tab.2 Pos.25) must be kept very close to the material (no farther than 5 mm. - 3/16 inches away) to obtain the maximum benefit from the air/water and air/chemical product mixtures.

b) Please note that spot removing does not depend on the quantity of water used, but on the water/air combination (as per point "a"). It is essential to insist on the spot using *water SPARINGLY* which also facilitates quicker drying. The lever (Tab.8 Pos.4) on the gun should be pressed gradually to obtain a pin-point water/air combination.

c) For resistant spots, neutral soap should be used to facilitate spot removal: on old, hard stains the occasional use of a brush may be necessary to help soap penetration.

d) Some spots of whitish, powdery, appearance may easily be removed by the air drying gun (Tab.2 Pos.26).

e) All stains originating from metallic oxides such as rust should be treated with our "**UNIVERSAL SPOTTER**" or other suitable product.

f) On showerproofed clothing where water/air penetration is low, spot removing and drying are more difficult. In these cases perseverance is necessary to obtain the best results.

g) For stains of greasy origin, the chemical product spraying gun should be used in the same way as previously outlined for the water gun.

h) When using the drying gun, the nozzle of the gun (Tab.9 Pos.11) should always be brought into perpendicular contact with the cloth to allow the maximum air penetration as in drawing N°2. It is not necessary to dry completely if the garment is to be pressed.

i) It is recommended to always use the machine with the vacuum switched "on".

These few suggestions, together with careful maintenance of the machine, will soon give the best results.

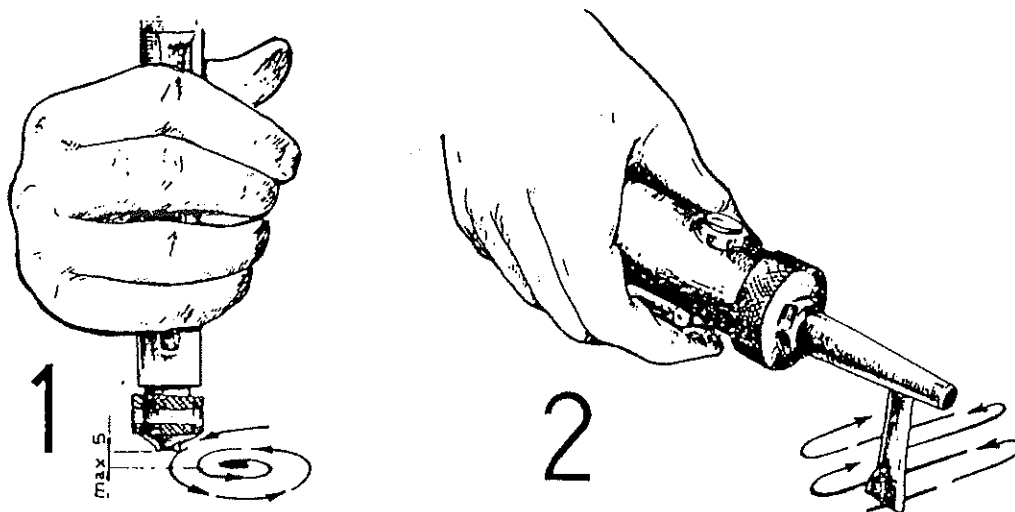

- 3.3 The spotting board HYDROSOLV Jr. is manufactured to guarantee the safety of the operator who has to be careful to avoid an improper set up and/or use of the machine.(Ex.: he has to avoid sharp edged objects near the machine in order not to have electric wires damaged and any objects that hamper the free flow of air to the motors).

No water/liquids must be used to clean the machine when the electrical instruments are switched on.

When particularly dense products are used for spotting, it is recommended to leave the vacuum switched on for some time after use, to permit the complete expulsion of all residues to avoid the blocking of the vacuum fan (Tab.2 Pos.9).

4 MAINTENANCE

- 4.1. ***To keep the machine working efficiently for a long time it is necessary to periodically execute the following controls:***

Every 3 days discharge the condensate of the pneumatic circuit.

Close the air input cock (Tab.2 Pos.2) which is on the air filter (Tab.2 Pos.3) and discharge air through drying gun (Tab.2 Pos.26), condensate will then flow out automatically from the air filter (Tab.2 Pos.3).

- 4.2 **Often used parts may in time start not to work properly, there is an easy solution:**

A) DRYING GUN : should the drying gun (Tab.2 Pos.26) not emit sufficient air or the air be mixed with condensate or foreign particles, the felt filter needs replacing (Tab.9 Pos.8).

B) SPOTTING GUN : if a spotting gun (Tab.2 Pos.25) does not emit solvent or water, check that there is sufficient liquid in the akulon container (Tab.2 Pos.4).

If it still does not work proceed as follows:

- 1) make sure that the inox filter which is inside the joint at the base of the akulon container is not obstructed.
- 2) unscrew the bush (Tab.8 Pos.1) and take off the head (Tab.8 Pos.7).
- 3) unscrew the nozzle (Tab.8 Pos.2) and carefully clean the nozzle using the air from the drying gun until the jet is seen to be free. Use a bristle if necessary, but NEVER metallic wire.
- 4) Now carefully reassemble all parts.

HYDROSOLV Jr. DIMENSIONS

TAB.1

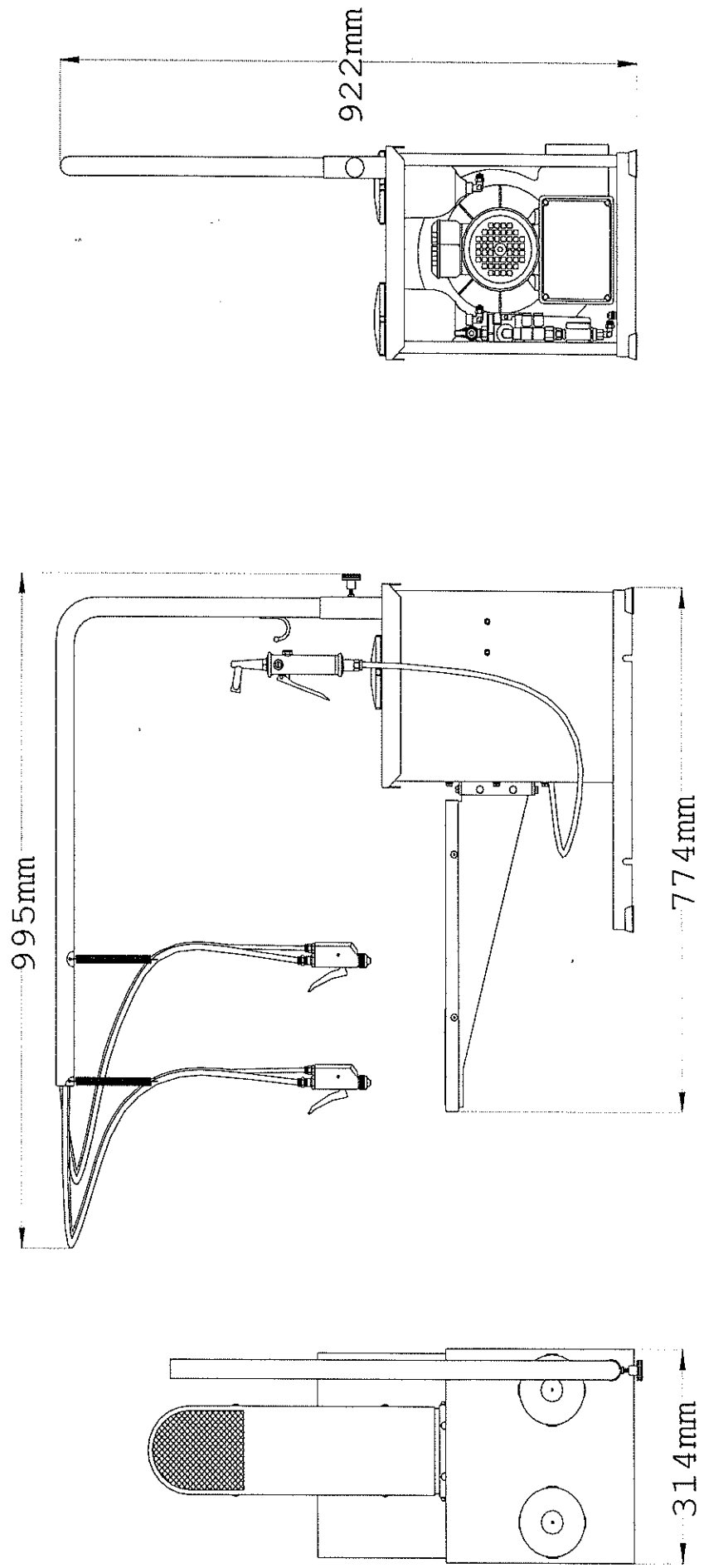

HYDROSOLV Jr.

HYDROSOLV Jr.

POS.	DESCRIPTION	COD. No	POS.	DESCRIPTION	COD. No
1	FEET	11.15021.1	16	PNEUMATIC ACTUATOR	06.20002
2	AIR INPUT COCK	01.18042	17	SET S.S MESH-S.S PLATE-PLA RIM FOR BIG ARM	11.18062
3	"RSC" FILTER	10.15014	18	S.S MESH FOR BIG ARM	11.15035
4	AKULON CONTAINER COMPLETE W/FITTING	11.15048	19	S.S PLATE FOR BIG ARM	11.16020
5	SINGLEPHASE VACUUM	05.20003	20	PLASTIC RIM FOR BIG ARM	11.15005.4
6	MOTOR FAN COVER	05.20007	21	RILSAN HOSE 8X6 FOR ST/1	11.15054.BABY
7	COOLING FAN	05.20006	22	RILSAN HOSE 6X4 FOR ST/1	11.15055.BABY
8	VACUUM MOTOR	24.18029	23	SPRAYING GUNS SUPPORT	07.15050.BABY
9	Ø 20 CM SUCTION FAN	05.20005	24	S STEEL SPRING FOR SPRAYING GUN	11.15024
10	BLACK NYLON HOUSING	05.20013	25	SPRAY GUN ST/1	11.17085
11	ELECT BOX COMPLETE SINGLEPHASE PNEUMATIC	11.30020	26	DRYING GUN	11.17071
12	FUSES HOLDER	06.20300	27	S STEEL BIG ARM	11.21080
13	ELECTRIC BOX FOR COD. 11.30020	06.20100	28	ENAMELED TABLE FRAME	07.15051.BABY
14	PNEUMATIC SWITCH	06.20020	29	ELASTOLLAN HOSE 8X6 FOR DRYING GUN	11.15053.BABY
15	MAGNETIC CONTACTOR	06.20006	30	HOOK FOR DRYING GUN	12.18049

HYDROSOLV JR.

TAB. 2

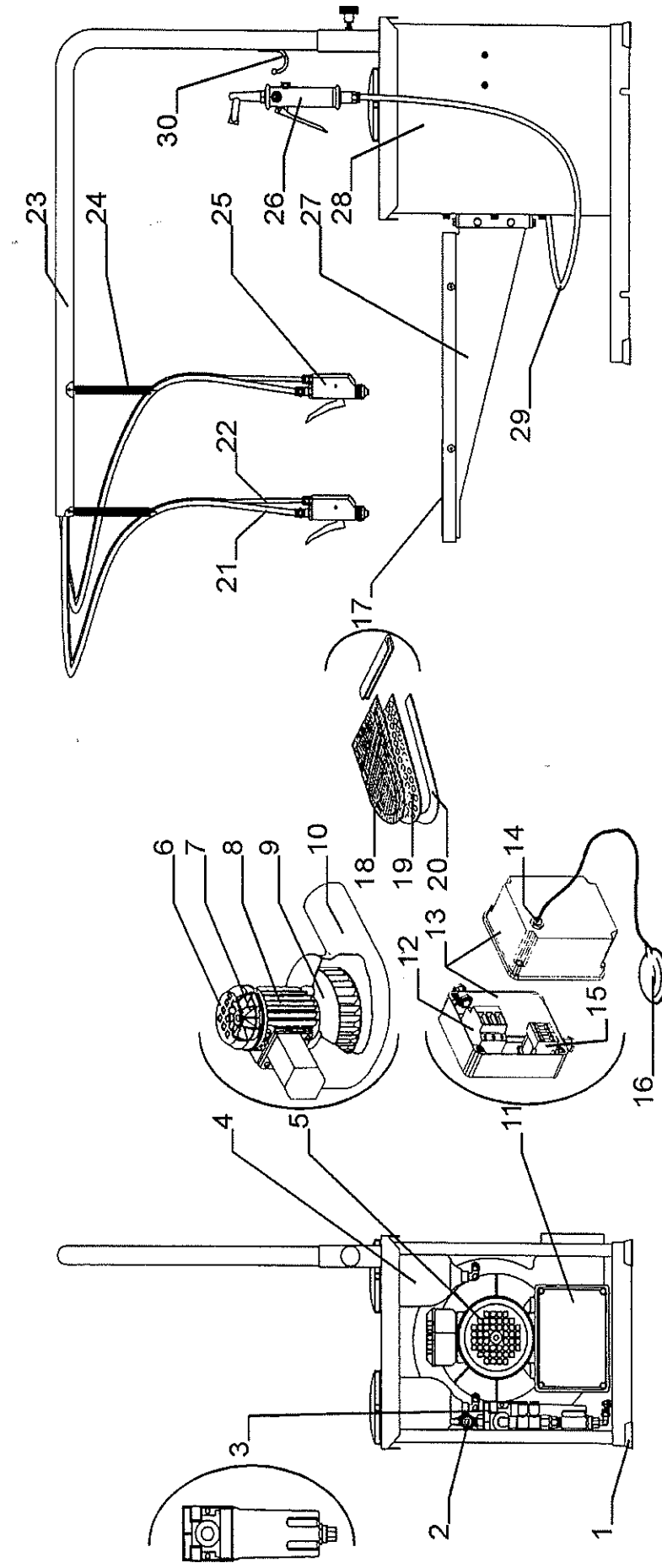

OPTIONAL x HYDROSOLV Jr.

OPTIONAL x HYDROSOLV Jr.

POS.	DESCRIPTION	COD. No	POS.	DESCRIPTION	COD. No
1	COMPLETE STEAM ATTACHMENT	11.00185	20	PLASTIC RIM FOR SMALL ARM	11.15005.2
2	AIR INPUT	*****	21	SET S.S.MESH-S.S.PLATE-PLA.RIM FOR BIG ARM	11.18062
3	WARNING LIGHT	06.18061	22	S.S.MESH FOR BIG ARM	11.15035
4	ELECTRIC SWITCH <96	06.20011	23	S.S.PLATE FOR BIG ARM	11.16020
4	ELECTRIC SWITCH >96	06.20022	24	PLASTIC RIM FOR BIG ARM	11.15005.4
5	AIR/STEAM HOSE	11.18040	25	COMPLETE ACTIVE CARBON FILTER	11.18016
6	MICROSWITCH FOR AIR/STEAM GUN 2Pcs.	11.18037	26	SUCTION AIRTEX HOSE	11.18016.T65
7	AIR/STEAM GUN	20.18007	28	SPRING FOR ACTIVE CARBON FILTER	07.18016.M
8	ELECTROVALVE COIL	06.18036.1	29	FLUXA PRE-FILTER	11.18018.1
9	ELECTROVALVE COMPLETE	06.18036	30	ACTIVE CARBON FILTER PANEL	10.18008
10	STEAM OUTPUT VALVE CLAPET	11.15079.1	31	"COLA" SOAP TANK - COMPLETE	11.18063
11	STEAM INOX TANK	07.SERB.INOX	32	AIR INPUT HOSE 25 BAR	11.18115
12	STEAM INPUT	*****	33	PRESSURE REGULATOR	01.00184/R
13	DISCHARGE VALVE CLAPET	01.15079.1	34	SAFETY VALVE	01.15079
14	THERMODYNAMIC STEAM TRAP (OPTION)	09.18038	35	EXTRAFLEX HOSE 6X4 FOR SPRAY BRUSH	11.18114
16	S.S. STEEL DOUBLE ARM	11.21090	36	SOAP CHARGE FUNNEL COMPLETE WITH FILTER	11.18065
17	SET S.S.MESH-S.S.PLATE-PLA.RIM FR SMALL ARM	11.18058	37	COMPLETE SPRAY GUN-BRUSH	11.18009
18	S.S.MESH FOR SMALL ARM	11.15034	38	SOAP CHARGE COCK	01.18066
19	S.S.PLATE FOR SMALL ARM	11.15023	39	CHEMICAL PRODUCTS HOLDER	11.15003

OPTIONAL x HYDROSOLV Jr.

TAB.3

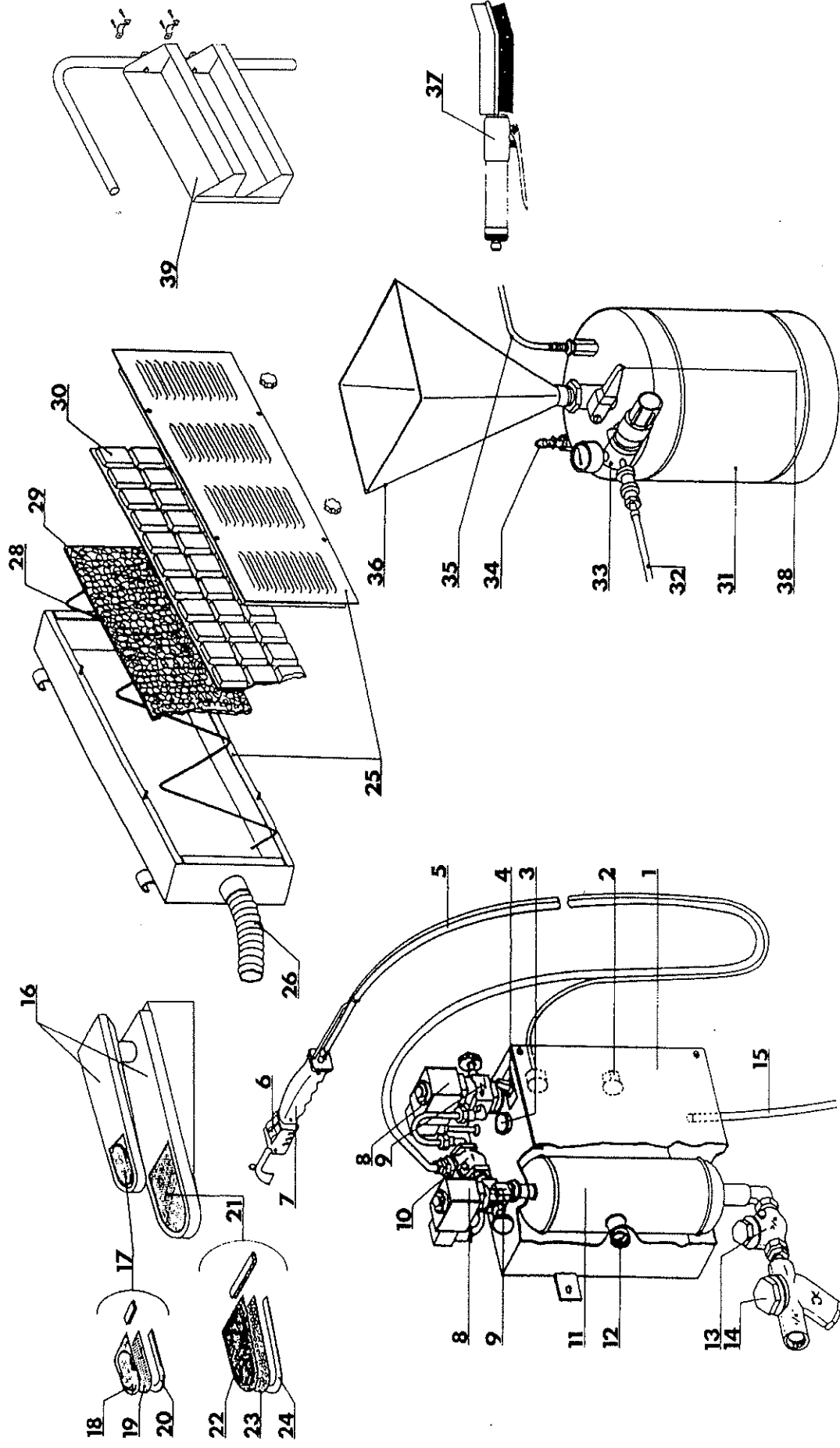

ELECTRIC SCHEME HYDROSOLV. Jr. SINGLEPHASE

TAB.4

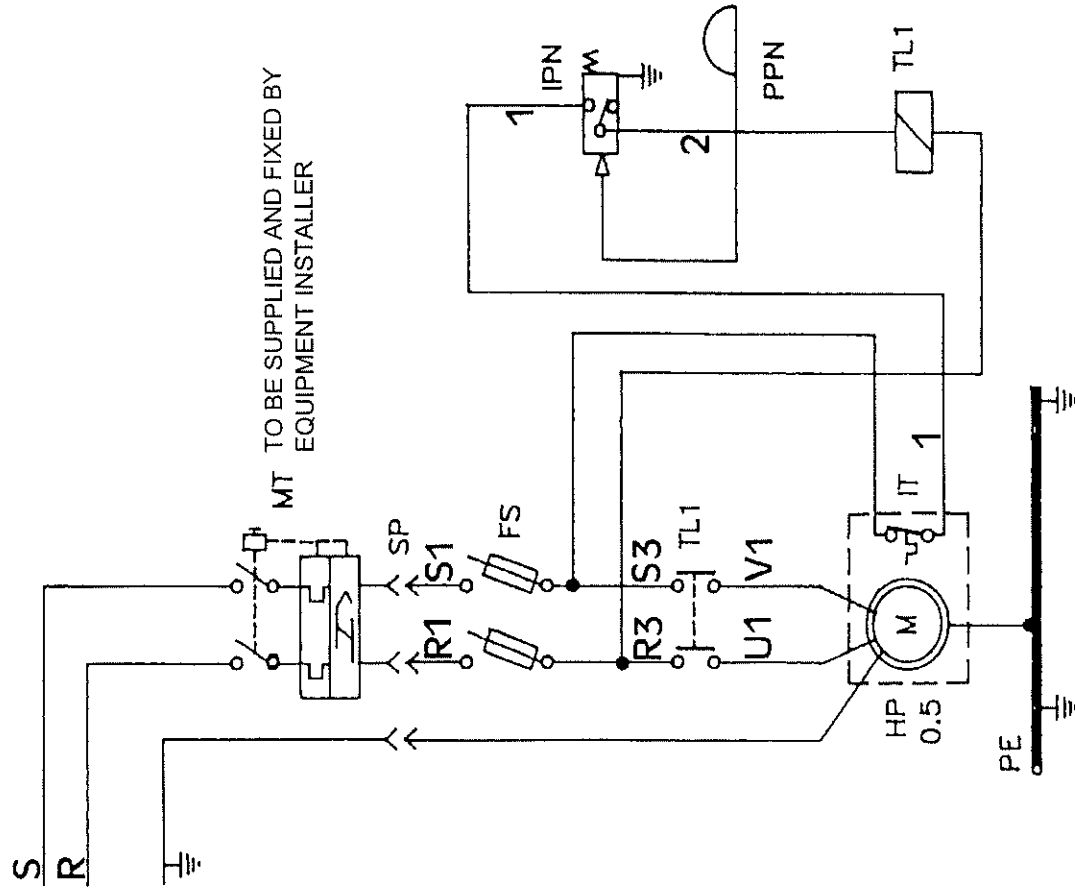

TYPE	DESCRIPTION	CODE.N°	TAB.2 POS.
IT	INTERNAL THERMAL CIRCUIT BREAKER	*****	*****
M	VACUUM MOTOR	24.18029	8
TL1	MAGNETIC CONTACTOR	06.20006	5
PPN	PNEUMATIC ACTUATOR	06.20002	6
IPN	PNEUMATIC SWITCH	06.20020	4
PE	GROUNDING TERMINAL CONNECTOR	*****	*****
FS	FUSES	06.20301	*****
SP	ELECTRIC PLUG	06.20201	*****
MT	MAGNETOTHERMIC SWITCH (To be supplied and fixed by equipment installer)	*****	*****

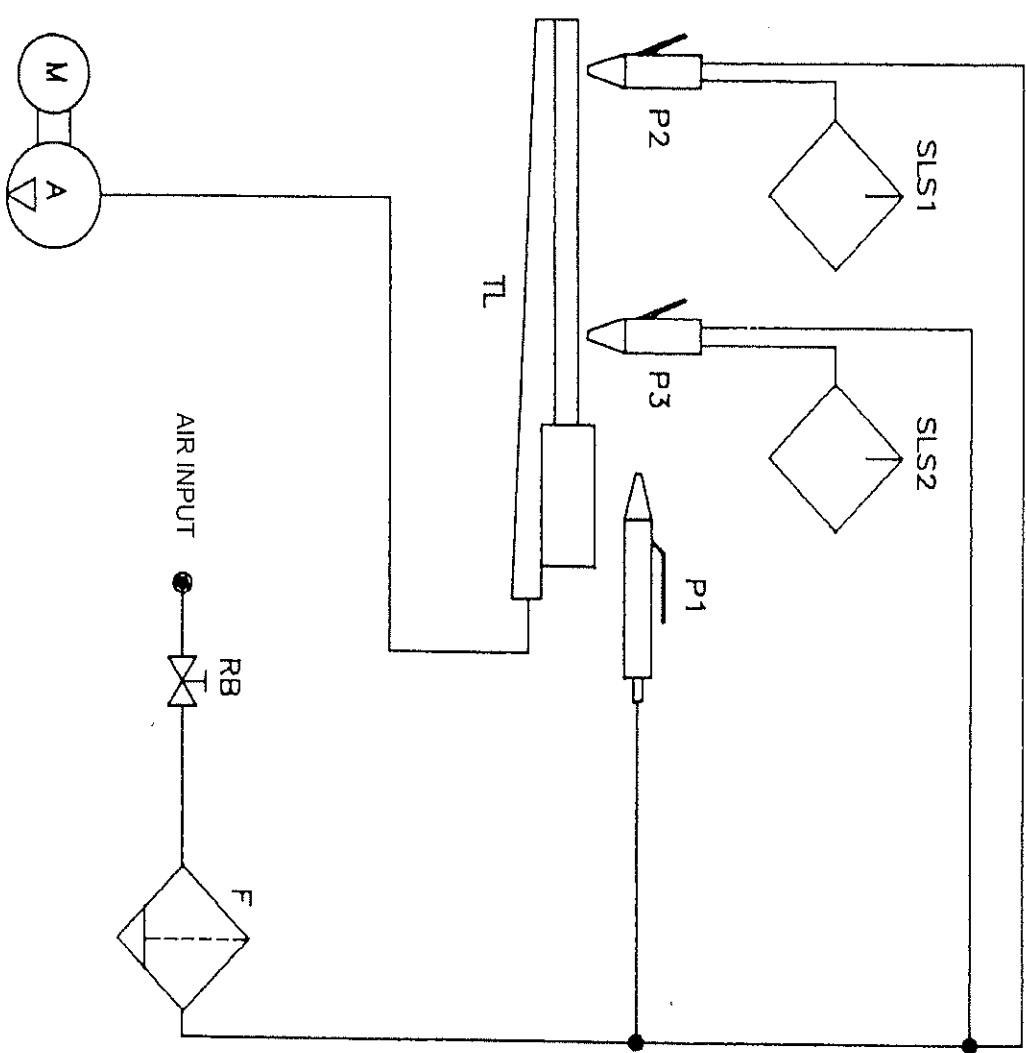

TYPE	DESCRIPTION	COD. N°	TAB.2 POS.
TL	WORKING TABLE	11.21080	27
SLS-1/2	LIQUID CONTAINERS	11.15048	4
P-2/3	SPOTTING GUNS	11.17085	25
P-1	DRYING GUN	11.17071	26
F	AIR FILTER	10.15014	3
RB	AIR COCK	01.18042	2
A	VACUUM	05.20003	5

STEAM ATTACHMENT-ELECTRIC SCHEME

TAB.5

TYPE	DESCRIPTION	CODE N°	TAB.3 POS.
INT	ELECTRICAL SWITCH	06.20022	4
L	WARNING LIGHT	06.18061	3
EV-2	STEAM ELECTROVALVE	06.18036	9
EV-1	AIR ELECTROVALVE	06.18036	9
PV	STEAM START-BUTTON	11.18037	6
PA	AIR START-BUTTON	11.18037	6
PE	GROUNDING TERMINAL CONNECTOR	*****	*****

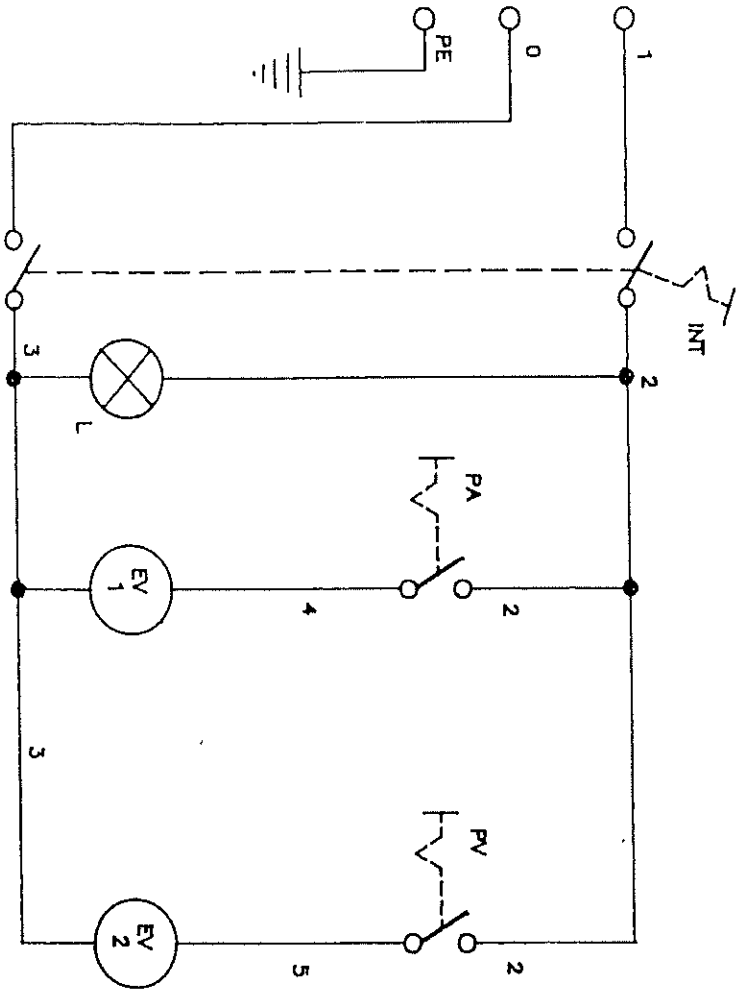

PNEUMATIC SCHEME HYDROSOLV Jr. WITH STEAM ATTACHMENT **TAB.7**

TYPE	DESCRIPTION	COD. N°	TAB.2/3 POS.
TL	WORKING TABLE	11.21080	27
SLS-1/2	LIQUID CONTAINERS	11.15048	4
P-2/3	SPOTTING GUNS	11.17085	25
P-1	STEAM/AIR GUN	20.18007	7
F	AIR FILTER	10.15014	3
RB	AIR COCK	01.18042	2
A	VACUUM	05.20003	5
VP	STEAM ATTACHMENT	11.185	1

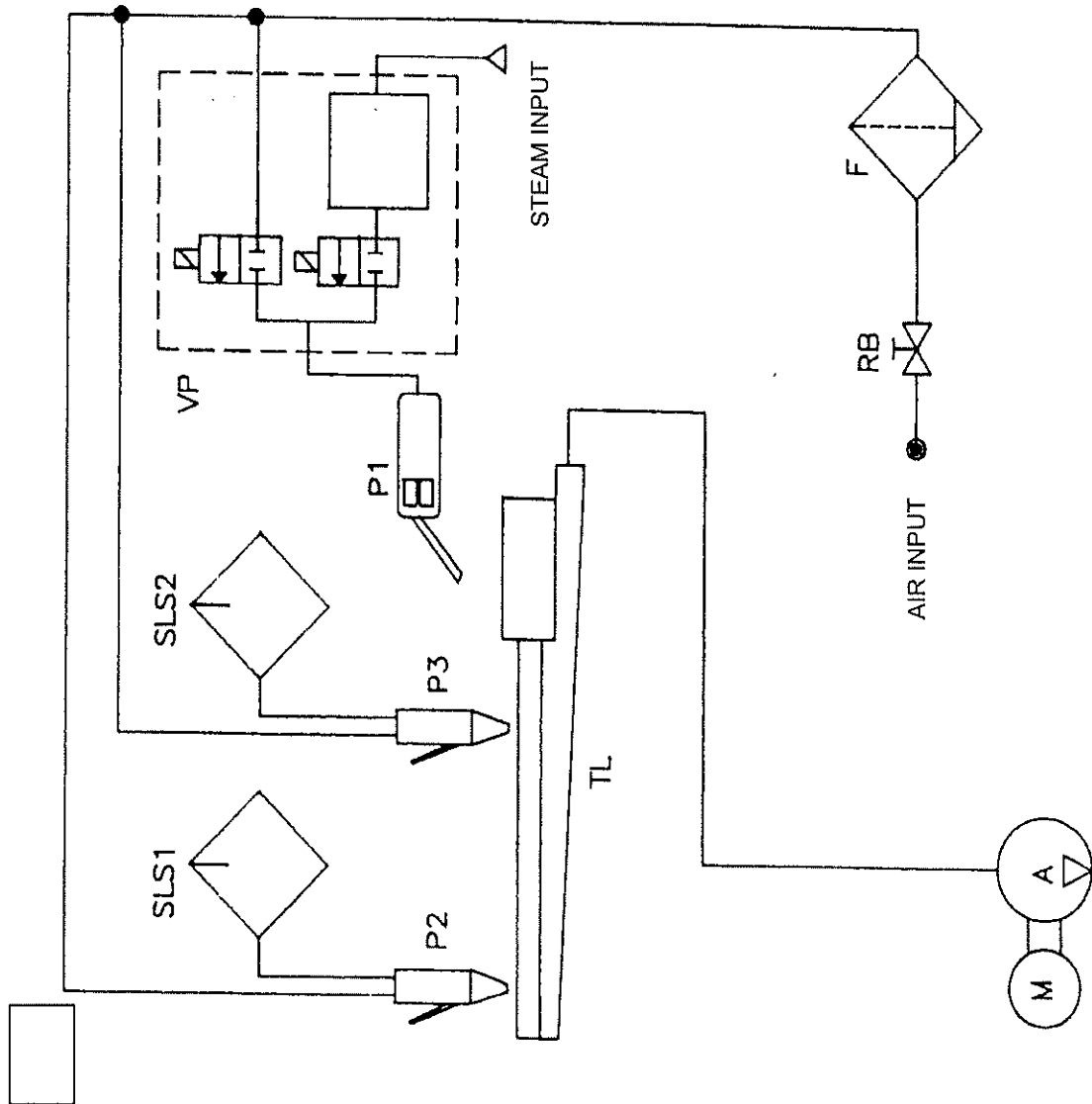

SPOTTING GUN ST/1

TAB.8

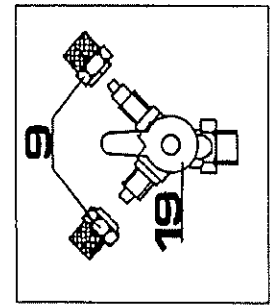
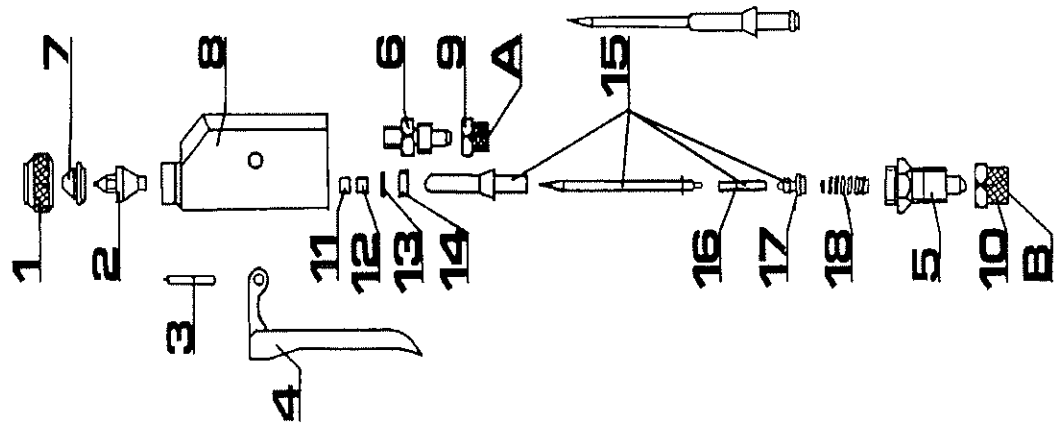

POS.	DESCRIPTION	COD.N°
1	THREADED BUSH	20.17037
2	NOZZLE	20.17038
3	PIVOT TRIGGER	20.17046
4	TRIGGER	20.17040
5	CONNECTION NYLON TUBE 6X8	01.17041
6	CONNECTION NYLON TUBE 4X6	01.17042
7	HEAD	20.17044
8	BODY	20.17045
9	NUT 4X6	20.17081
10	NUT 6X 8	20.17083
11	TEFLON PACKING	20.17047
12	THREADED BUSH 7 MA	20.17048
13	PACKING	20.17049
14	THREADED BUSH 11 MB	20.17050
15	BUSHING HOLDER COMPLETE W/PIN	11.17051
16	BUFFER SHOCK-ABSORBERS	20.17052
17	PIVOT CONNECTION SPRING	20.17053
18	PIN SPRING	20.17054
19	LIQUID DIVERTER COCK	01.17084
A	WATER/CHEMICAL PRODUCT INLET	*****
B	AIR INLET	*****

DRYING GUN

TAB.9

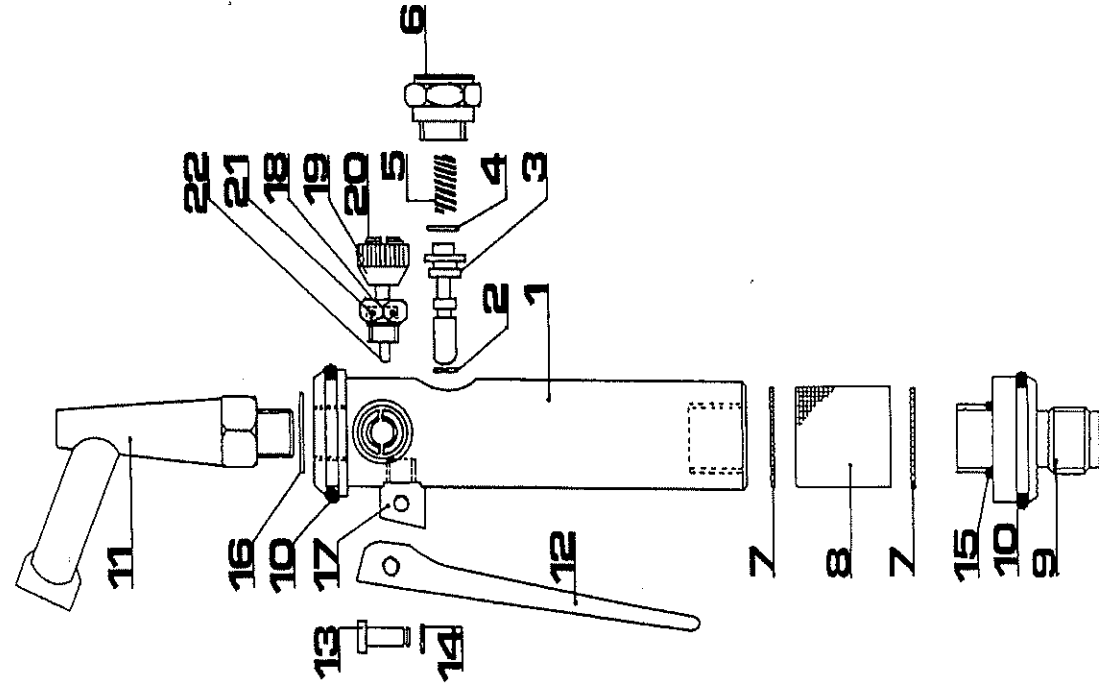

POS.	DESCRIPTION	COD N°
1	GUN BODY	20.17056
2	GASKET	20.17057
3	SHAFT	20.17058
4	GASKET	20.17059
5	SPRING	20.17060
6	NUT	20.17061
7	INOX FILTER	20.17062
8	FILTER FELT	20.17063
9	BUSH	20.17064
10	RUBBER RING	20.17065
11	NOZZLE	20.17066
12	LEVEL	20.17067
13	PIN	20.17068
14	RADIAL RING	20.17068.1
15	GASKET	20.17069
16	GASKET	20.17070
17	LEVEL SUPPORT	20.17072
18	VALVE BODY	20.17073
19	HAND-WHEEL	20.17074
20	SHAFT NUT	20.17075
21	GASKET	20.17076
22	SHAFT	20.17077

SPRAY GUN-BRUSH

TAB.10

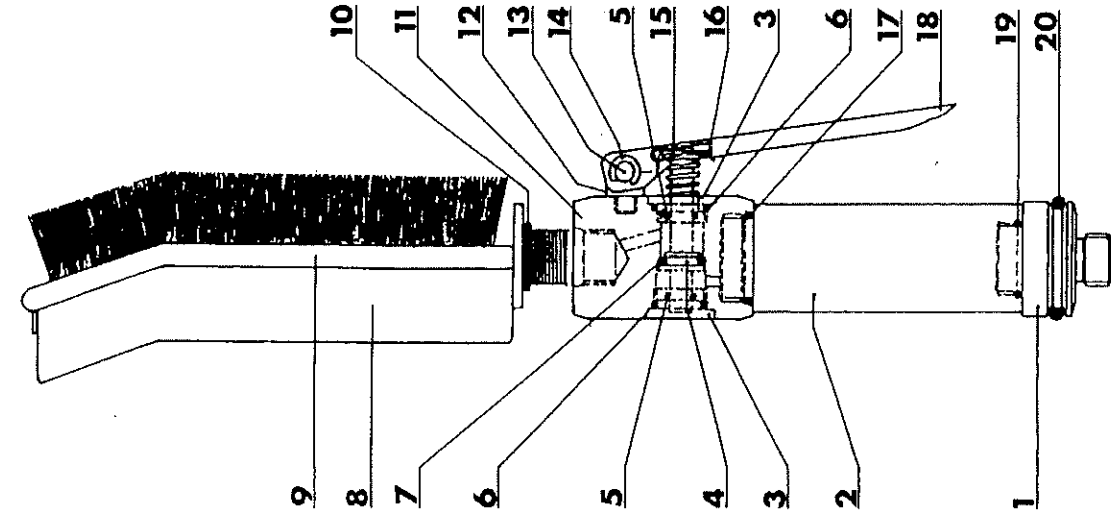

POS.	DESCRIPTION	COD.N°
1	BUSH	20.17064
2	GUN HANDLE	20.18103
3	BUSHING HOLDER	20.18107
4	SHAFT	20.18112
5	VITON OR GASKET	20.18110
6	VITON OR GASKET	20.18108
7	VITON OR GASKET	20.18111
8	BRUSH	20.18013
9	S STEEL HOSE	07.18113
10	NYLON GASKET	20.17070
11	GUN BODY	20.18104
12	LEVEL SUPPORT	20.17072
13	LEVEL PIN	20.17068
14	RADIAL RING	20.17068.1
15	SPRING	20.18105
16	SPRING STOP	20.18106
17	VITON OR GASKET	20.18109
18	LEVEL	20.17067
19	VITON OR GASKET	20.17069
20	RUBBER RING	20.17065